

# HILLBILLY

# BRAKE

BETTER THAN A STICK

6292 Old Troy Pike  
Urbana, OH 43078

833-990-2725  
Info@HillbillyBrake.com

# INSTALLATION INSTRUCTIONS

## Honda Talon X/X4/R/R4 Parking Brake Model - T1000



### WARNING:

Always place the vehicle shift lever to **'PARK'** when the Hillbilly Brake™ is **'ON'**.

Read entire instructions and review illustrations prior to beginning.

(1) 8mm Serrated  
Flange Nut



(1) 8mm x 16mm  
Button Socket  
Cap Screw



**MOUNTING  
HARDWARE**

13mm Combination Wrench



5mm Hex Wrench

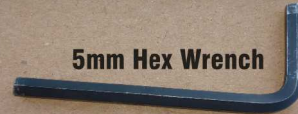

**Required Tools**

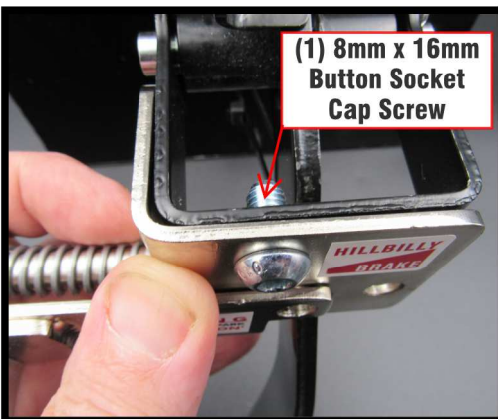

**Step #1**  
Install the Hillbilly Brake™ assembly around the brake pedal bracket. Insert (1) 8mm x 16mm button socket cap screws through the front hole and slot in the front of the brake bracket.

**Step #2**  
Install (1) 8mm serrated flange nut on the 8mm button socket cap screw. **Note: DO NOT** tighten hardware completely until the brake assembly is positioned properly.

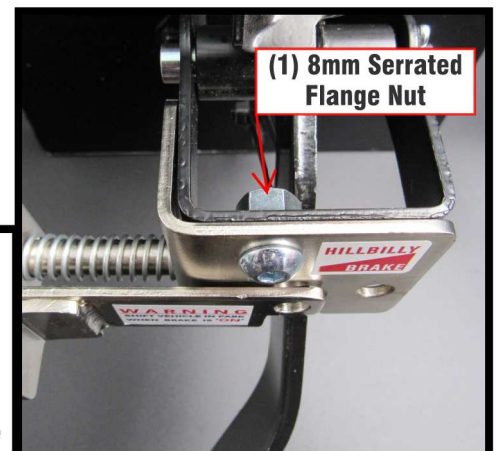



**Step #3**  
 Adjust the Hillbilly Brake™ unit so that it is even with the top edge of the brake pedal bracket. It should also be tight against the front face and side of the brake pedal bracket. Finger tighten the flange nut to hold the Hillbilly Brake™ assembly in the proper position.

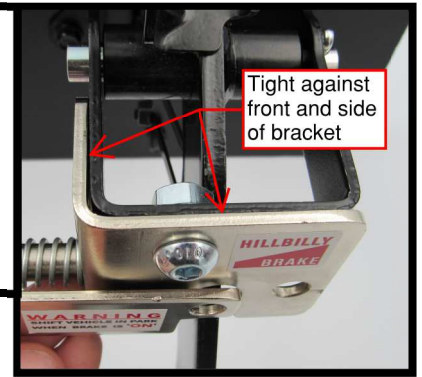

**Step #4**  
 Tighten hardware completely.

**\*\* TIP \*\***

The serrated 8mm flange nut should not need to be held with a wrench, but if it does start to turn insert a 13mm box end wrench as shown while depressing the the brake pedal. This is the only area that the wrench will fit behind the brake mount.



Read the Operating Instructions for proper use and maintenance.



If brake pedal feels too hard to push and engage the slide arm, adjust the brake pedal position by making adjustment at the back of the brake pedal arm.

**Brake Pedal Adjustment**

**Liability Statement**

**WARNING** the vehicle transmission shift lever must ALWAYS be placed in 'PARK' when the Hillbilly Brake™ is 'ON'.

The Hillbilly Brake™ is designed as a secondary system to assist with parking on a hill and to help prevent damage to the vehicle transmission gears. Always use extra precautions when parking on slopes or inclines, never allow persons to stand in path of vehicle down the slope or incline. The Hillbilly Brake™ relies on the vehicle braking system to hold the vehicle on a slope or incline, the vehicle braking system must be in proper working condition to use the Hillbilly Brake™.

By purchasing and installing the Hillbilly Brake™ product, user agrees that should damage occur, Hillbilly Brake™, LLC will not be responsible for loss of time, use, labor fees, replacement parts, or freight charges. Hillbilly Brake™, LLC, nor any 3rd party, will not be responsible for any direct, indirect, incidental, special, or consequential damage that result from this product. The total liability of seller to user for all damages, losses, and causes of action, if any, shall not exceed the total purchase price paid for this product.

Installing, adding, modifying, or fabricating any factory or aftermarket product to your ATV/UTV may violate certain local, state, and federal laws. Be advised that laws vary depending on town, city, county, state, etc. Use of certain products on public streets, roads, or highways may be in violation of law. The buyer is solely and exclusively legally and personally responsible for any violation of the law by the installation or use of the product. You must abide by all local, state, and federal laws, including but not limited to vehicle safety, traffic laws, and ordinances. It is your responsibility to know the laws and how they apply to you.

The buyer is responsible to fully understand the capability and limitations of his/her vehicle according to manufacturer specifications, warnings, and instructions and agrees to hold Hillbilly Brake™, LLC harmless from any damage resulting from failure to adhere to such specifications, warnings, and/or instructions. The buyer is also responsible to obey all applicable federal, state, and local laws and ordinances when operating his/her vehicle while using this product, and the buyer agrees to hold Hillbilly Brake™, LLC harmless from any violation thereof.

Hillbilly Brake™, LLC assumes no responsibility for damage to your UTV, or personal injury by using our product and services. Our hill brake is designed to help protect your UTV transmission from extreme conditions as much as possible. You are using our products and services at your own risk. Always practice safe driving.

Locking the Hillbilly Brake™ with the operator's own lock will secure or immobilize the UTV, but this is only a deterrent and Hillbilly Brake™, LLC issues no guarantee against theft or loss of property. Use precaution and additional means as necessary to prevent theft or loss of property.



**HILLBILLY**  
**BRAKE**  
BETTER THAN A STICK

6292 Old Troy Pike  
Urbana, OH 43078

833-990-2725  
Info@HillbillyBrake.com

# OPERATING INSTRUCTIONS

## Honda Talon X/X4/R/R4 Parking Brake Model - T1000

### **OPERATING INSTRUCTIONS:**

#### **To Engage the Hillbilly Brake™**

1. Press the vehicle brake pedal and hold down to stop the vehicle.
2. Place the vehicle shift lever to 'PARK'.
3. Push and HOLD the Hillbilly Brake™ action arm towards the passenger side of the vehicle with your foot or hand. Holes will be aligned when the brake is on.
4. Release the brake pedal while holding on the action arm and the brake pedal will be held in the engaged position.

#### **To Disengage the Hillbilly Brake™**

1. Press the brake pedal and the Hillbilly Brake™ will automatically disengage.

#### **Recommended Maintenance:**

After every interior cabin wash or cleaning, it is recommended that the user lubricate the slide pin with 2-3 drops of 3 in 1 oil or similar type lubricant.

## **WARNING:**

**Always place the vehicle shift lever to 'PARK' when the Hillbilly Brake™ is 'ON'.**

Read entire instructions and review illustrations prior to using this product.

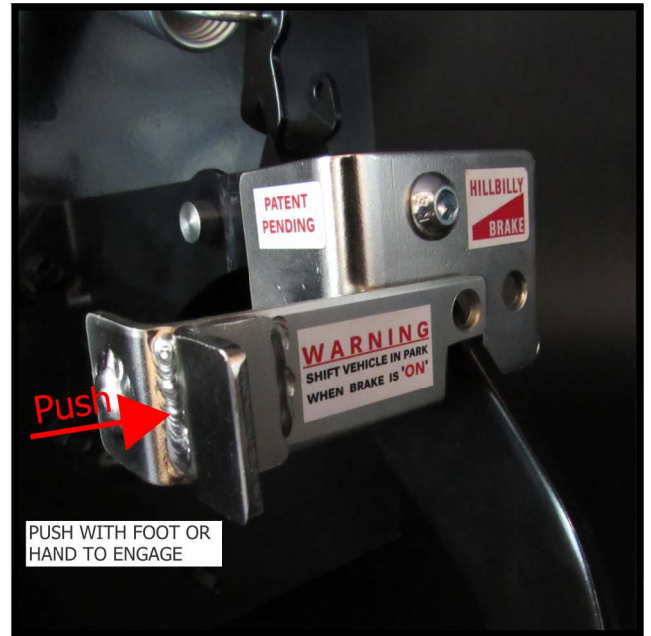

**To Secure the Hillbilly Brake:**  
**Align the (2) holes in the front of the brake assembly and insert a pad lock with a 5/16" diameter shackle.**

### **Liability Statement**

**WARNING** the vehicle transmission shift lever must ALWAYS be placed in 'PARK' when the Hillbilly Brake™ is 'ON'.

The Hillbilly Brake™ is designed as a secondary system to assist with parking on a hill and to help prevent damage to the vehicle transmission gears. Always use extra precautions when parking on slopes or inclines, never allow persons to stand in path of vehicle down the slope or incline. The Hillbilly Brake™ relies on the vehicle braking system to hold the vehicle on a slope or incline, the vehicle braking system must be in proper working condition to use the Hillbilly Brake™.

By purchasing and installing the Hillbilly Brake™ product, user agrees that should damage occur, Hillbilly Brake™, LLC will not be responsible for loss of time, use, labor fees, replacement parts, or freight charges. Hillbilly Brake™, LLC, nor any 3rd party, will not be responsible for any direct, indirect, incidental, special, or consequential damage that result from this product. The total liability of seller to user for all damages, losses, and causes of action, if any, shall not exceed the total purchase price paid for this product.

Installing, adding, modifying, or fabricating any factory or aftermarket product to your ATV/UTV may violate certain local, state, and federal laws. Be advised that laws vary depending on town, city, county, state, etc. Use of certain products on public streets, roads, or highways may be in violation of law. The buyer is solely and exclusively legally and personally responsible for any violation of the law by the installation or use of the product. You must abide by all local, state, and federal laws, including but not limited to vehicle safety, traffic laws, and ordinances. It is your responsibility to know the laws and how they apply to you.

The buyer is responsible to fully understand the capability and limitations of his/her vehicle according to manufacturer specifications, warnings, and instructions and agrees to hold Hillbilly Brake™, LLC harmless from any damage resulting from failure to adhere to such specifications, warnings, and/or instructions. The buyer is also responsible to obey all applicable federal, state, and local laws and ordinances when operating his/her vehicle while using this product, and the buyer agrees to hold Hillbilly Brake™, LLC harmless from any violation thereof.

Hillbilly Brake™, LLC assumes no responsibility for damage to your UTV, or personal injury by using our product and services. Our hill brake is designed to help protect your UTV transmission from extreme conditions as much as possible. You are using our products and services at your own risk. Always practice safe driving.

Locking the Hillbilly Brake™ with the operator's own lock will secure or immobilize the UTV, but this is only a deterrent and Hillbilly Brake™, LLC issues no guarantee against theft or loss of property. Use precaution and additional means as necessary to prevent theft or loss of property.